



*Step Into
My World*
2019 Celebrating Connections

**Celebrating Connections 2019
Conference Program**

April 10-12, 2019 • Charleston, WV

LISTEN...
To dynamic national, state and local speakers who will motivate and entertain you.

LEARN...
Knowledge that will bring you up-to-date on current early care and education practices.

ENJOY...
Stimulating conversation while exchanging ideas with other professionals.

**Celebrating
Connections
2019**



Index

Welcome to Celebrating Connections.....	2
Celebrating Connections Agenda at a Glance.....	3
Conference Notes and General Information.....	4-7
Making the Most of Your Registration.....	8
What's New in 2019.....	9
Wednesday One Day Institutes.....	10-11
Wednesday Three Hour Sessions.....	12
Thursday Keynote Speaker.....	13
Thursday Concurrent Sessions: 10:30 AM-12:00 PM.....	14-16
Thursday Concurrent Sessions: 1:30-4:30 PM.....	18-20
Friday Spotlight Speakers.....	21
Friday Concurrent Sessions: 10:30 AM-12:00 PM.....	22-24
Friday Concurrent Sessions: 1:30-3:00 PM.....	25-27
Charleston Civic Center Map.....	28
Conference Registration Information and Form.....	29-31
Hotel Information and City Map.....	32
Continuing Education Reporting Form.....	33
Certificate of Attendance.....	34

Welcome to Celebrating Connections 2019

“Step Into My World”

The early childhood programs of West Virginia welcome you to the 22nd annual Celebrating Connections Conference. The success of the early childhood community begins with you as educators. Your enthusiasm is the reason for Celebrating Connections’ success. This year’s conference has been designed to provide relevant information about practices, policies, planning and research that enhances community partnerships and quality in early care and education. You will also have the opportunity to network with other professionals and participate in a diverse array of early childhood education discussions. All those involved in the conference would like to thank you for your continued dedication to young children.

Your Conference Program

Contained within this program is all the information you will need to be an active participant in this conference. Regardless of whether you are seeking information about the conference sessions, program presenters, or other events, you should take the time to familiarize yourself with its contents. Please note registration instructions and forms are located in the back of this program. Make sure to bring this program to the conference as it will serve as a valuable reference for you.

For more information, call West Virginia Early Childhood Training Connections and Resources at 1-888-983-2827.

West Virginia’s 22nd Annual Early Childhood Conference is sponsored by:

- WV Department of Education:
 - Office of Early and Elementary Learning
- WV Dept. of Health & Human Resources:
 - Bureau for Public Health/Office of Maternal, Child and Family Health/ WV Birth to Three & West Virginia Home Visitation Program
 - Bureau for Children and Families/Division of Early Care and Education
 - WV Head Start State Collaboration Office

Conference Planning Committee

Ginger Huffman, Chair
LeAnn Ruddle, Coordinator

- | | |
|--------------------|-------------------|
| Michele Baranaskas | Brooke Hunter |
| Suzi Brodof | Teresa Lawlor |
| Melanie Clark | Jackie Newson |
| Michelle Comer | Pam Roush |
| Trella Coppola | Elizabeth Teel |
| Alyson Edwards | Debbie Withrow |
| Rhonda Fisher | Mel Woodcock |
| Olivia Gregorich | Sheila Zickefoose |

Special thanks to the staff of WVECTCR for all their assistance.

Conference Objectives

- Promote effective and positive practices when working with children and families.
- Highlight state and local programs which demonstrate effective practices with young children and families.
- Share information regarding community collaboration.
- Provide networking opportunities for the early childhood community.
- Learn practical solutions for community involvement and supporting families.
- Create an opportunity for early childhood programs to better understand each other through common experiences.
- Create opportunities to learn about program specifics such as policies, standards, and transition procedures for Head Start, public/private/special education preschool, Early Head Start, child care, WV Birth to Three, Home Visitation, and the Universal Pre-K system.
- Develop strategies to advocate for young children and families in the state within early care and education.
- Create an environment that fosters collaboration within the early care and education community.

Celebrating Connections--Agenda at a Glance

Time	One Day & 3 Hour Sessions Wednesday, April 10	General Conference Thursday, April 11	General Conference Friday, April 12
7:30 am	On-Site Registration begins (7:30 am-4:30 pm) Enjoy refreshments and browse the Exhibit Hall (7:30 am-4:30 pm)	On-Site Registration begins (7:30 am-5 pm) Enjoy refreshments and browse the Exhibit Hall (7:30 am-5 pm)	On-Site Registration begins (7:30 am-12 noon) Enjoy refreshments and browse the Exhibit Hall (7:30 am-1:30 pm)
8 am	Visit the Recharge Room 8-9 am 12-1:30 pm	Visit the Recharge Room 8-10:30 am & 12-1:30 pm	Visit the Recharge Room 8-10:30 am & 12-1:30 pm
8:45 am		Morning Announcements (8:15-8:30 am)	Spotlight Speakers (8:30-10:00 am) Stephanie Staples (Little Theater) Ellen Booth Church (South Hall)
9 am	One Day Institutes 9:00 am-4:00 pm 3 Hour Conference Sessions 9:00 am-12:00 pm	Keynote Address (8:30-10:00 am) Brandon Williams	
10:15 am		Break 10:00-10:30 am	Break 10:00-10:30 am
10:30 am			
11 am		Conference Sessions 10:30 am-12 noon	Conference Sessions 10:30 am-12 noon
11:30 am			
12 noon	Networking Lunch for purchase or lunch on your own (12-1 pm)	Networking Lunch for purchase or lunch on your own (12 noon-1:30 pm)	Networking Lunch for purchase or lunch on your own (12 noon-1:30 pm)
1 pm	One Day Institutes continued until 4 pm 3 Hour Conference Sessions 1:00 pm-4:00 pm Exhibit Hall closes at 4:30 pm		ACDS Reception 12:15-1:15 pm
1:30 pm		Conference Sessions 1:30-4:30 pm	Conference Sessions 1:30-3 pm
3 pm			
4:30 pm		Exhibit Hall closes at 5:00 pm	Exhibit Hall closes at 1:30 pm
5 pm			

Conference Notes & General Information

Where Is the Conference Located?

Celebrating Connections 2019 will be located at the Charleston Civic Center across the street from the Town Center Mall in downtown Charleston, West Virginia. Parking at the Civic Center parking garage is \$3 per day. Town Center Mall parking is \$1.75 per day. Thankfully construction on the building is now complete, so all sessions will take place in the renovated Charleston Civic Center.

Is There a Central Information Office at the Conference?

Information about special events, restaurants, shopping, entertainment, transportation, places of interest in Charleston, first aid or other emergency needs, and a lost and found is available at the Information Desk in the Registration Area. You may also contact the Charleston Visitor's Bureau for more area information at (304)344-5075.

Accessibility

While every effort is made to ensure this conference is as barrier-free as possible, some challenges may still exist. Your expertise and feedback in barrier identification will allow us to remedy these areas of concern for future events.

Community Bulletin Boards

Visit our Community Bulletin Board located in our Registration Area for information on the job market, last minute conference changes, and community events. Conference participants may post their qualifications or job vacancies here. Conference staff may also post last minute communication about conference changes here, although most changes will be communicated through our Conference Facebook page. Anyone attending the conference is also encouraged to share information about local community events for early childhood professionals or families.

Electronic Handouts

Now for the fourth consecutive year, handouts will be available on the Celebrating Connections website for participants to print prior to attending the conference. Visit www.wvearlychildhood.org before the conference to print your handouts. As we move forward with this effort of "going green", please note that no handouts will be given out during the conference.

Children at the Conference

Please do not bring children to the conference with you while you attend sessions. It can be disruptive to the professional learning atmosphere when young children are in the sessions.

A Word of Caution

Unfortunately, losses and thefts occur whenever large numbers of people meet. Please exercise adequate precautionary measures. The Civic Center and conference sponsors are not responsible for the loss or theft of any item.

What is the Exhibit Hall and When is it Open?

The Exhibit Hall is a central area where participants can browse various information booths of area businesses related to the early childhood field. When visiting the Exhibit Hall, be sure to stop by the information desk located at the back of the hall to pick up your copy of our Exhibitor Scavenger Hunt. Participating in this fun and engaging Scavenger Hunt will allow you the opportunity to win one of the many prizes donated by our generous exhibitors. The Exhibit Hall will be open during the following times:

- Wednesday, April 10, 2019 7:30 am-4:30 pm
- Thursday, April 11, 2019 7:30 am-5 pm
- Friday, April 12, 2019 7:30 am-1:30 pm

Conference Notes & General Information

What Are the Benefits of Registering Early and How Do I Register?

Registering early not only helps ensure workshop selections, but is also the greatest savings. You can save up to \$50.00 by registering early!

Early registration deadline is March 15, 2019. Registrations must be POSTMARKED by this date or they will be returned UNPROCESSED. If your registration is returned, you need to bring your registration form and payment with you to the conference for on-site registration. Only check, credit card, purchase order, or money order will be accepted as forms of payment. No cash will be accepted. For more information on registration, see page 29.

When Can I Register On-Site?

On-site registration and other information will be provided at the registration table and will adhere to the following schedule:

- Wednesday, April 10, 2019 7:30 am-4:30 pm
- Thursday, April 11, 2019 7:30 am-5 pm
- Friday, April 12, 2019 7:30 am-12 pm

Please note that cash will not be accepted as a form of payment.

Why Does My Name Badge Have a List of Workshops On It?

If you pre-register, you will receive your name badge and confirmation letter in the mail. Your name badge serves as your ID card for the conference by admitting you to all workshop sessions and special events. Your badge indicates the workshops you pre-selected to attend. DO NOT LOSE YOUR CONFERENCE NAME BADGE. If you lose your name badge, please contact the WVECTCR office at 304-529-7603 or 888-983-2827 as soon as possible. If you are unable to call, please go to the conference registration area designated "help line." Conference committee members will be available to help you with any

questions you might have regarding this process. Help us reduce waste by recycling your badge holder. Just drop it off at the registration area with your overall conference evaluation in the designated box before leaving the conference.

How Can I Receive Credit for Continuing Education Units (CEUs)?

During each workshop, presenters will pass around a CEU sign-in sheet. You must complete this sign-in sheet in order to receive full credit for attendance. Please see page 6.

Are There Stipends Available?

Stipends are available for PARENTS OF CHILDREN WITH SPECIAL NEEDS BIRTH THROUGH 8 and CHILD CARE PROVIDERS who are unable to receive financial support from their affiliated agency. Stipends will be available beginning February 25, 2019. As part of receiving stipend support to attend the conference, stipend recipients will be asked to monitor one or more of their sessions. Monitoring includes assisting the presenter as needed (if requested), passing out attendance sheets, etc. Monitors will receive an instruction sheet with all the directions needed to complete this task and a list of the assigned sessions. Celebrating Connections will also be offering additional stipends this year for those specifically living in the greater Huntington area. This is a result of the generosity of the former Huntington Area Early Childhood Conference (HAECC). Please contact conference coordinator LeAnn Ruddle for more details.

If you are interested in applying for a stipend, please contact LeAnn Ruddle at West Virginia Early Childhood Training Connections and Resources (WVECTCR) at 304-529-7603 or 888-983-2827 for eligibility and award amounts. Stipends are available on a first-come, first-serve basis and funds are LIMITED. Stipends will be awarded based upon number of days of atten-

Conference Notes & General Information

dance. Child care centers will be limited to 3 stipends. WVECTCR reserves the right to decline an application for a stipend at any time. If you receive a stipend and are unable to attend the conference, please let WVECTCR know immediately so the funds can be allocated to someone else.

Reading the Workshop Descriptions

Workshop descriptions explain the presentation content and identify who benefits most from each workshop. Participants are encouraged to read each description thoroughly before making final selections.

The word LIMITED means the presenter has asked for the number of participants to be limited. The conference committee respects this limit in order to enhance the learning environment. Register as early as possible to maximize your chances of getting the workshop you want. All other workshop limits are based on the audience seating capacity of the room (based on fire safety code). Workshops will close when room capacity is reached.

In an effort to help you make informed decisions, each presenter has indicated the training content targeted area for each session. Please use the following legend to help you choose your sessions:

Training Content Targeted Area:

- I - Infants
- T - Toddlers
- P - Preschoolers
- S - School Age
- M - Mixed Age Groups
- SN - Children with Special Needs
- A - Adults (content not applicable to a child's age)
- HV - Home Visitation

One Day Institutes and Concurrent Conference Sessions

One day institutes are in-depth, practical workshops scheduled for 6 hours on Wednesday. Concurrent sessions are 3 hours offered in the morning and afternoon on Wednesday and Thursday afternoon. Shorter 1.5 hour concurrent sessions are also offered on Thursday morning, and Friday morning and afternoon.

WV Core Knowledge and Competencies

West Virginia's Core Knowledge and Competencies for Early Childhood Professionals are a core body of knowledge relating to the developmentally appropriate, family-centered, and child-nurturing practices needed by all those who care for and educate young children. The core competencies are necessary to promote the optimal development of all children, including those with special needs, and to address the needs of families. The workshops presented at the 2019 Celebrating Connections Conference meet contact hours for Early Care and Education Competencies and Infant/Toddler Mental Health Competencies.

Continuing Education Units (CEUs)

The conference committee is working to receive approval for graduate credit (must attend 3 days of the conference) and CEUs in Social Work, Nursing, WV Birth to Three, WV STARS, Physical Therapy, Occupational Therapy, Speech Language Pathology, Counseling, and Professional Development Graduate Hours. For more information regarding CEUs, please visit our website, www.wvearlychildhood.org, or ask a conference staff member at the conference.

In order to receive CEUs for each session, you must be present for the entire session and sign the attendance sheets. Please note that in order to receive credit from WV STARS, you must sign in with your correct name and STARS number.

Conference Notes & General Information

Use the CEU certificate in the back of this program to record your participation. Please review your CEU/licensing certification requirements before attending the conference. We hope this will be helpful to you when applying for credit when you return home.

Please do not give or send the conference committee any of your CEU forms or information. We do not submit your CEU forms to your licensing body. Monitors will not pass around attendance sheets until the last 15 minutes of the session, and no exceptions will be made to this rule.

Smoking

Smoking is not permitted in the Charleston Civic Center.

Fire Safety

To prepare for the unlikely event of a fire or other emergencies requiring rapid departure, please locate all exit doors and routes upon entering any room.

Where Can I Eat Lunch?

A networking luncheon is planned for Wednesday through Friday of the conference. The buffet luncheon will be served at the Civic Center. The cost of the buffet is approximately \$12.00. There are also numerous restaurants within walking distance.

Courtesy

Please be courteous to your fellow participants and presenters by turning off cell phones and limiting talking during presentations.

Accommodations for Nursing Mothers

A room will be designated for nursing mothers who need to pump during the day. Please see the registration desk for more information.

Evaluation/Feedback

The conference committee members do not get a chance to attend the sessions or participate in every conference-related activity. Therefore, we would like not only your suggestions, but your compliments, so we can discover what works and what should be changed. Please take time to complete the overall conference evaluation form so we can continue to produce a quality conference. We appreciate and value your feedback.

Early Childhood Resource Lending Library (ECRLL)

The ECRLL is a statewide resource and lending library for early childhood providers. Be sure and visit the Exhibit Hall where a display of resource materials and resource lists will be available.

Social Media

Keep up with everything Celebrating Connections related by following us on Facebook. We encourage you to use this social media outlet to keep up-to-date on exciting announcements leading up to the conference and to stay informed on any last minute changes during the week of the conference. By following us on Facebook, you could also get the chance to win a FREE conference registration. Also, don't forget to use #wvcc19 when posting any photos or sharing information while at the conference for a chance to win a FREE conference registration.

Returning in 2019!

Recharge Room

We invite you to visit our Recharge Room, which will be located in Room 201 on the second floor of the conference center. This is a space where conference participants can come to recharge their minds, bodies, and cell phones. Drop by and recharge your cell phone and relax for a little while with some upbeat music, stress relieving activities, and some fun! Allowing time for you to recharge, relax, and refocus can help you get the most out of all of your sessions.

Making the Most of Your Registration

Follow these easy steps to ensure registration accuracy.

- Read program thoroughly.
 - Fill out the Conference Registration Form completely and accurately.
 - ✓ It is important to list the address where you want your name badge to be sent before the conference.
 - ✓ Please list a direct phone number, not the number to your regional office. If we have questions while processing your registration, we will need the specific phone number to contact you.
 - Mark 3 choices for each workshop session time.
 - ✓ As noted on the Conference Registration Form, you are to select three choices for each workshop session time. Because some of the sessions have participant limits, it is not always possible to fulfill your first request. Indicating additional choices will better your chances of attending a session of your choice.
- NOTE: IF YOU DO NOT INDICATE OTHER CHOICES, SESSIONS WILL BE ASSIGNED TO YOU.
- Attach check, credit card information, money order, or purchase order for payment.
 - Mail/submit registration form _____ (record date here for your records).
 - ✓ All early registrations must be postmarked by March 15, 2019.

Conference Checklist

Consider bringing these items to the conference to make your experience enjoyable.

- ✓ Conference program
- ✓ Name tag and Confirmation Letter
- ✓ Comfortable clothing
- ✓ Sweater or jacket for cool rooms
- ✓ Comfortable shoes
- ✓ Change for vending machines
- ✓ Money to purchase lunch
- ✓ Notepad, pencil and pen
- ✓ Money for Exhibit Hall

Be sure to make your hotel reservations!

WHAT'S NEW IN 2019?



The RECHARGE Room Returns

Visit our RECHARGE room to not only recharge your cell phone at our charging station, but relax and recharge your body and minds with some fun activities.

Located on the second floor in room 201.

Use

#WVCC19

When posting pictures at the conference for a chance to win a **FREE** conference registration!



Stay up to date on conference announcements, last minute changes, and fun contest by following us on Facebook and Instagram

Between 2018 and 2019 we gave away **16 FREE** conference registrations through our Social Media Giveaway series on Facebook!

Also, be sure to follow us on our new Instagram [@celebratingconnectionsww](#)

CONSTRUCTION IS COMPLETE!

The construction of the Civic Center is now complete!

This means all sessions will be held on site in the newly renovated space.



HIGHLIGHTS

- New Nationally Recognized Presenters!
- New Exhibitors!
- New and improved Exhibitor Scavenger Hunt! See the Celebrating Connections staff at the exhibit hall information desk for more details.

Wednesday, April 10, 2019

One Day Institutes, 9:00 am-4:00 pm

A-1

Using Play-Based and Routines-Based Observation to Examine Executive Function in Young Children

Level: Basic

ECE Core Knowledge: Child Growth and Development; Family and Community Relationships; Child Observation and Assessment

ITMH Competency: Infant/Very Young Child Development and Behavior; Observation and Listening
Training Content Targeted Area: M

Executive function develops at an incredibly rapid pace during the preschool years, beginning shortly after birth. Ellen Galinsky and others have highlighted executive function as a critical preschool skill necessary for later success. Yet, experts like Peter Anderson and Natalie Reidy tell us that few attempts are made to assess executive processes in young children. Dr. Thomas Brown, a psychiatrist at Yale University believes that observing a person's ability to perform self-managed tasks of everyday life provides a much better measure of executive function. Harvard's Center on the Developing Child tells us that babies aren't born with the essential executive function and self-regulation skills, but they are born with the potential to develop them. It is imperative that we examine the executive functioning of young children in order to develop individualized plans to achieve these essential skills.

Presenter: Barbara Kuczen, Ph.D., Professor Emeritus, Author, and Early Childhood Consultant, Chicago, IL

A-2

Infant and Toddler Trauma: Caring for Yourself While Caring for Others

Level: Basic

ECE Core Knowledge: Child Growth and Development; Family and Community Relationships; Child Observation and Assessment; Health, Safety and Nutrition; Professionalism and Leadership; Administration and Management

ITMH Competency: Infant/Very Young Child & Family Centered Practice; Family Relationships & Dynamics; Observation and Listening; Self-Awareness; Emotional Response

Training Content Targeted Area: M

This workshop will explore the impact of trauma on both infants/toddlers and their caregivers as well as on

the professionals working with the family. Discussion will focus on signs and symptoms of trauma as well as coping strategies for caregivers and professionals to address compassion fatigue. Reflective supervision will be highlighted as a necessity in this type of work. Infant mental health strategies, case studies, and a group activity will be incorporated to support discussion as well as provide opportunities to identify trauma symptoms and practice skills.

Presenters: Christine Raches, PsyD, HSP, BCBA and Elesia Hines, PsyD, HSP, Riley Child Development Center - LEND, Indiana University School of Medicine, Indianapolis, IN

A-3

Nurturing the Substance-Exposed Young Family: Hope in the Face of Adversity

Level: Advanced

ECE Core Competency: Child Growth and Development; Family and Community Relationships; Child Observation and Assessment; Professionalism and Leadership

ITMH Competency: Infant/Very Young Child Development & Behavior; Infant/Very Young Child & Family Centered Practice

Training Content Targeted Area: I, A, HV

The fact that many adults struggling with Substance Use Disorders (SUDs) are already parents or pregnant and expecting or both is often a source of tremendous concern for society and indeed, can compound judgment and stigma conferred upon individuals already battling a debilitating disease. However, this fact also offers a profoundly important opportunity to address SUDs through the lens and portal of the parent-infant relationship. Infant and early childhood practitioners across childcare, early education, home visitation, and health and human services have the ability to enhance care and outcomes for parents with Substance Use Disorders and the youngest survivors of the opioid epidemic: the infants born with Neonatal Abstinence Syndrome and ongoing effects of prenatal substance exposures. The first 100 days of life hold highly consequential biological and behavioral shifts in the development of the infant brain. This workshop will explore the unique ways in which early infant behavior and development offers a pathway into supporting both children and parents in their recovery.

Presenter: Jayne Singer, PhD, Director at Brazelton Touchpoints Center, Boston, MA

A-4

CAPS Poverty Simulation

Level: Basic

ECE Core Knowledge: Family and Community Relationships

ITMH Competency: Responding with Empathy; Self-Awareness; Cultural Competence

Training Content Targeted Area: M

A unique tool that helps people begin to understand what life is like with a shortage of money and an abundance of stress. During a simulation, participants role-play the lives of low-income families, including single parents, people with disabilities, and senior citizens on Social Security. This will include having stations for potential points of contact (landlord, pawn shop, utility company, grocery store, jail, etc.)

Presenter: Jackie Newson, Director, WV Home Visitation Program, Office of Maternal, Child, and Family Health, WV Department for Health and Human Resources, Charleston, WV

A-5

How to Incorporate Low Tech AAC Throughout Your Day (Core, Visuals, and a Few Surprises)

Level: Intermediate

ECE Core Knowledge: Child Growth and Development; Family and Community Relationships; Child Observation and Assessment; Environment and Curriculum; Professionalism and Leadership

ITMH Competency: None

Training Content Targeted Area: SN

This session will describe how the developmental specialist, preschool teacher, and speech-language pathologist can work cooperatively to create an environment rich in opportunities to participate and communicate for all children. During the presentation, several strategies such as aided-language stimulation, providing visual supports, partner-assisted scanning, and using low tech to no tech augmentative communication will be demonstrated and practiced during hands-on activities. Low tech strategies will be provided for not only communication with modifications for disabilities, but for participation. The use of core vocabulary as a starting point for establishing a communication system as well as early literacy will be explained, and hands-on activities will be used to show the importance. Ways the speech-language pathologist can model the use of the low tech to no tech communication system for the Birth to Three

developmental specialist, preschool teacher, and staff will be presented. We will take the daily schedule of a preschool classroom and discuss a variety of means for establishing communication opportunities during each segment of the day. Participants are welcome to bring their preschool schedule to use. Participants will have make and take sessions throughout the day to provide low tech augmentative communication alternatives, three participation activities, a functioning daily schedule with communication opportunities infused, and classroom visual supports to take back to the classroom to use immediately. We will also discuss ways to take data while service providers co-teach. Preschool or Birth to Three teams should try to participate together to get the full effect of the team approach.

Presenter: Lee Ann Brammer, M.A., CCC-SLP, Coordinator, WVDE, Charleston, WV

A-6

JUST FOLLOW THE LEADER: Oh, I'm the Leader!

Level: Intermediate

ECE Core Knowledge: Professionalism and Leadership; Administration and Management

ITMH Competency: Building and Maintaining Relationships; Supporting Others

Training Content Targeted Area: A

Strong early childhood leadership positively impacts outcomes for children and families. But very few leaders arrive in their roles with all of the experience, education, or specialized training they need. Leadership in early childhood programs is directly linked to child outcomes. Fostering collective leadership requires trust-building, navigating power and privilege, and addressing inequities in relationships. This session will help you develop skills for shared-decision making, role rotation, and reflection that will empower you and your team to find solutions and reach your shared goals. In this interactive session, we will cover topics such as; leadership styles, communicating and sharing a vision, conflict resolution, guiding staff's professional development while encouraging and recognizing staff, team building, empowering a shared leadership culture, since leadership can occur from anywhere, any position. So whether you are a seasoned or new leader, or will one day be stepping into the role, we all have something to share and discover.

Presenter: Lillian McCuen, MA, Psychology, Professional Development Consultant, Lakeshore Learning Materials, Philadelphia, PA

Wednesday, April 10, 2019

Three Hour Sessions

9 am-12 pm

B-1

Continuing a Conversation About Race

Level: Basic

ECE Core Knowledge: Professionalism and Leadership

ITMH Competency: Self-Awareness; Cultural Competence

Training Content Targeted Area: M,A

A Conversation About Race was born in 2016 when three women from Appalachia—an MFA poet, a housing coordinator serving the chronically homeless, and a business owner—were guided toward one another at the same time. They collided with an opportunity to develop a presentation on “race”. This is the third conversation. Whether you are returning or new to the conversation, there is something for everyone. As we discover our collective history together, you are creating history too. Please join us.

Presenters: Crystal Good, Artist, Advocate, Entrepreneur, Charleston, WV; Briana Martin, Covenant House, Charleston, WV; Leslie Stone, Stone Strategies, LLC, Cross Lanes, WV

B-2

Journey of Hope for Caregivers, Facilitator Training

Level: Intermediate

ECE Core Knowledge: Family and Community Relationships

ITMH Competency: Self-Awareness

Training Content Targeted Area: A

Designed to strengthen supportive and effective learning environments for children, the Journey of Hope for Caregivers workshop promotes the emotional well-being of teachers, administrators, parents, social workers, and child care providers. To give children the support they need, child caregivers need stable and cohesive communities where they can learn and grow together. These communities help caregivers process recent events, cope with current challenges, and realize that their emotional health directly impacts their ability to care for children.

Presenter: Tony (Jose) Richards, MPH, Senior Program Specialist, Psychosocial Support Programs, Save the Children, South Charleston, WV

1-4 pm

C-1

Come! Design! Activities to Promote Economic Success in the 21st Century

Level: Basic

ECE Core Knowledge: Child Growth and Development; Family and Community Relationships

ITMH Competency: None

Training Content Targeted Area: A

Do you like designing children’s activities? Is there too little time to think and design innovative experiences that teach valuable concepts in an exciting way? Come to this session for design time. We’ll review seven values critical to economic success. Then you’re free to create exercises that teach the seven values to any chosen age group. Bring your smart phone, creativity, and your school’s lesson plan format, or use our generic format. Note: We will not be teaching how to design lessons. This is a time for those who love lesson design to create.

Presenter: Leslie Stone, Stone Strategies, LLC, Cross Lanes, WV

C-2

Reflection Through the Arts: Easy Practices for Busy Early Care Professionals

Level: Basic

ECE Core Knowledge: Professionalism and Leadership

ITMH Competency: Contemplation

Training Content Targeted Area: A

Early intervention professionals are increasingly working with young children and families who are under stress with significant challenges, leading to concerns for secondary trauma and work burn out. Finding time for reflection and self-care is important, but often overlooked in our busy lives. Join us for this interactive session to learn meaningful, but easy art and writing activities that build reflective practice and extend your self-care tool kit in fun ways.

Presenters: Julie A. LaCreta, BS, LACA and Angela Tomlin, PhD., HSPP, IMH-E®, Indianapolis, IN

Keynote Presentation

Thursday, April 11, 2019
8:30-10:00 am
South Hall

“Children Value Adults Who
Play With Them”

**Presented by Brandon Williams,
Early Childhood TLC, Pittsburgh, PA**



Children value adults who play with them, but the way adults interact with children inside the home and school has changed drastically over recent years. The constant demand to gather and document information often drives the daily activities of many teachers and early care providers. Daily “bonding activities” between parents and children have been diluted by contraptions, gadgets, and the need to capture each moment on a cellular phone. Let’s get back to the basics of child development to help connect children’s minds and bodies by playing with them.

Brandon Williams has been working in the field of early childhood education for over 12 years in a variety of settings. His experience includes leading movement-based classes with children and families, teaching in lab and center-based

Pre-K programs, and providing teachers with instructional feedback.

From 2006-2013, Brandon served as a featured member of the I am Moving, I am Learning (IMIL) national training team. Today, he offers training and consulting services as the owner of Early Childhood TLC (Teacher Learning Consultant). He holds a B.A. in Health and Physical Education Teacher and an M.A. in Child Development and Family Studies. He has been a certified Classroom Assessment Scoring System (CLASS) observer since 2014 and has provided instructional feedback to over 40 teachers. Brandon is known for his upbeat, energetic, and comedic style of presenting.

Thursday, April 11, 2019

Concurrent Morning Sessions, 10:30 am-12:00 pm

D-1

Sensory Processing Disorder 101

Level: Basic

ECE Core Knowledge: Child Growth and Development; Environment and Curriculum

ITMH Competency: Infant/Very Young Child Development and Behavior

Training Content Targeted Area: M

Sensory Processing Disorder is a term we are hearing more and more in our world. In this presentation, we will explore what sensory processing disorder is, briefly touching on the prevalence of this disorder. We will spend the bulk of the presentation discussing the different types of sensory processing disorder and how to support children with these disorders in your preschool environment with simple activities that will benefit all children in your class.

Presenter: Ingrid M. Kanics, OTR/L, FAOTA, President, Kanics Inclusive Design Service, LLC, New Castle, PA

D-2

Psychology in the Pre-K Classroom

Level: Basic

ECE Core Knowledge: Child Growth and Development; Environment and Curriculum; Health, Safety and Nutrition

ITMH Competency: None

Training Content Targeted Area: P, S

Psychology in the Pre-K Classroom delivers an interdisciplinary approach to teaching psychology in the early education setting. In this interactive presentation, participants will engage in hands-on learning experiences and receive a comprehensive unit plan aligned to the West Virginia Early Learning Standards Framework, (special emphasis is placed on addressing each social-emotional objective).

Presenters: Angela Curfman, Assistant Professor of Teacher Education, West Liberty University, West Liberty, WV and Anna Malone, Teacher Candidate, West Liberty University, West Liberty, WV

D-3

Switch Access: What is it and What Does it Do?

Level: Basic

ECE Core Knowledge: Child Growth and Development; Environment and Curriculum

ITMH Competency: None

Training Content Targeted Area: M, SN

The majority of the population is unfamiliar with switch access and the many doors it can open for individuals with disabilities. Many people do not realize these mysterious devices can increase independent play, inclusion opportunities, and access to the environment. This session will introduce participants to the different types of switches available, how to choose a switch, and the many activities for all ages that can be adapted for switch access.

Presenter: Jessi Wright, WVATS Program Manager, WVUCED, Morgantown, WV

D-4

Facilitating Transitions of Children and Families from WV-BTT to Pre-K

Level: Basic

ECE Core Knowledge: Family and Community Relationships

ITMH Competency: Service Delivery Systems

Training Content Targeted Area: SN

In the reauthorization of the IDEIA, a mandated process of transition is described for young children as they approach the age of 36 months, from Part C and Part B services. A carefully charted process is in place, which is intended to enhance the smoothness of this transition experience. This session is designed to help participants explore and understand the concerns, priorities, and resources of families and children who are on the threshold of this transition, and to consider strategies and supports for the transition.

Presenter: Diane Smith Grych, PhD., Adjunct Instructor, Early Childhood Regents Bachelor of Arts, Concord University, Athens, WV

D-5

Feltboard Fun

Level: Basic

ECE Core Knowledge: Child Growth and Development; Family and Community Relationships; Child Observation and Assessment; Environment and Curriculum

ITMH Competency: None

Training Content Targeted Area: P

Learn more about felt boards and unique finger plays and toe plays. Presenter will demonstrate how to make a felt board and felt pieces. Preschool teachers and child care providers who teach ages 2-4 are the prime target age range that this training will deal with, but infant and school age teachers will also gain knowledge from this workshop. Sign language teachers may find the visual aid of felt boards beneficial.

Presenter: Michelle Powell, AAS, Workshop Presenter, Felt Lady, Euclid, OH

D-6

Fun Transition Techniques for Your Pre-K Classroom

Level: Intermediate

ECE Core Knowledge: Environment and Curriculum

ITMH Competency: None

Training Content Targeted Area: P

Transitions can be tough, especially if children are asked to sit still and remain quiet while simply waiting. This session will identify the various types of transitions teachers must plan throughout the day. Activities for each type of transition will be demonstrated.

Presenter: Brandon Williams, MA, Education Consultant, Early Childhood TLC, Pittsburgh, PA

D-7

Early Head Start's Approach for Tuning into Young Parents

Level: Basic

ECE Core Knowledge: Family and Community Relationships

ITMH Competency: Building & Maintaining Relationships; Community Resource

Training Content Targeted Area: A

Early Head Start (EHS) provides intensive and comprehensive services that promote parental health and

well-being as the cornerstone to their child's successful early development. In this interactive session, we will cover the components of the EHS home-based program and home visiting strategies to use when working jointly with teen parents, infants, and toddlers. In this session, participants will learn how the EHS relationship-based approach can support adolescent development, reduce teen parents' isolation, and foster parenting skills and family economic mobility. We will feature ways that home visiting strategies can buffer young parents' stress and build on resilience for adolescents living in these circumstances. As home visitors focus on the partnership building that develops between staff and young parents, there are many wonderful opportunities to decrease family adverse experiences by strengthening parent-child relationships and overall family well-being.

Presenter: Patty Marickovich, MS.Ed., MIECHV Coordinator, Office of Head Start, Washington, DC

D-8

Resilience: The Biology of Stress and the Science of Hope

Level: Basic

ECE Core Knowledge: Health, Safety and Nutrition

ITMH Competency: Infant/Very Young Child & Family-Centered Practice

Training Content Targeted Area: M

As the documentary film *Resilience* reveals, TOXIC STRESS can trigger hormones that wreak havoc on the brains and bodies of children, putting them at greater risk for disease, homelessness, prison time, and early death. No segment of society is immune. *Resilience*, however, also chronicles the dawn of a movement that is determined to fight back. Trailblazers in pediatrics, education and social welfare are using cutting-edge science and field-tested therapies to protect children from the insidious effects of toxic stress. This session is appropriate for any professional of any level working with children of any age and their families.

Presenters: Michele Baranaskas, LCSW, Coordinator, Partners in Community Outreach, South Charleston, WV and Nonie Roberts, Training Specialist, Partners in Community Outreach, Charleston, WV

D-9

Impact of Vision and Hearing Impairment on Child Development and Learning

Level: Basic

ECE Core Knowledge: Child Growth and Development; Environment and Curriculum

ITMH Competency: Infant/Very Young Child Development & Behavior

Training Content Targeted Area: SN

For children with vision and hearing loss, access to information is limited, having implications for development and learning. Service providers need to understand the impact that has on the child, how to effectively get the information to the child in an understandable way, and how to determine if the child is clearly understood. People serving these children, infants through school age, need to incorporate suggested practices into the child's routines and educational plan.

Presenter: Ruth Ann King, WV SenseAbilities Coordinator, WVDE, Charleston, WV

D-10

Creating Stories with STEAM

Level: Basic

ECE Core Knowledge: Environment and Curriculum

ITMH Competency: None

Training Content Targeted Area: M

During this session, participants will participate in building and creating stories with loose parts and spheros. We will discuss how the children created settings and stories to bring to life with 3-D structures, videos, and the use of technology. Classroom videos will be shared from these experiences and then the participants will actively participate in their own creative story.

Presenter: Amber Myers, MA, Pre-K/K Curriculum Specialist, Harrison County Board of Education, Fairmont, WV

D-11

Create Your Own Calm in a Sometimes Crazy World (Part 1)*

Level: Intermediate

ECE Core Knowledge: Child Growth and Development; Child Observation and Assessment; Environment and Curriculum

ITMH Competency: Self-Awareness

Training Content Targeted Area: P

Early care and education professionals will learn how to use a positive behavior support system, with an emphasis placed on the Conscious Discipline program. Brain

states will be demonstrated so participants can understand how to maintain and promote self-regulation. This is the first part of a two part course. *Both Part 1 and Part 2 are required to obtain CEUs.

Presenter: Jane Haddox, BA, Early Education Station, Director/Owner, Pt. Pleasant, WV

D-12

Supporting Literacy Behaviors in the Early Childhood Classroom

Level: Intermediate

ECE Core Knowledge: Child Growth and Development; Environment and Curriculum

ITMH Competency: None

Training Content Targeted Area: P, S

In this workshop for teacher of preschoolers, we will analyze how to select texts for shared and interactive read-aloud, examine the teaching routines of interactive read-aloud and writing, as well as shared reading and writing instructional approaches, and plan an interactive read-aloud and writing lesson.

Presenter: Jeffrey Leffler, Ph.D., Interim Director, Southern Early Childhood Association, Hattiesburg, MS

D-13

Home Visitor Safety

Level: Basic

ECE Core Knowledge: Health, Safety and Nutrition; Professionalism and Leadership; Administration and Management

ITMH Competency: Exercise Sound Judgment

Training Content Targeted Area: M, HV

Home visitors will discover how to safeguard themselves from physical dangers, mental burnout, and certain legal risks. Participants will learn how to spot potential threats and techniques to maximize safety before, during and after a home visit. Discover resources to protect your mental health and your online presence as well. Learn how to create policies and procedures that keep you safe.

Presenters: Gregg Oxley, CQI Consultant WVHVP, Charleston, WV and Michelle Romanek, MA, CQI Consultant WVHVP, Wheeling, WV

Date: April 12, 2019

Join the Celebration



ACDS 30th Anniversary

- ★ What: ACDS 30 Year Anniversary Celebration
- ★ When: April 12 from 12:15 to 1:15
- ★ Where: Celebrating Connection Conference 2019

The Apprenticeship for Child Development Specialist (ACDS) program is celebrating 30 years at the Celebrating Connections Conference! We will be honoring apprentices, journeypersons, instructors, mentors and council members. Plan to join us for this event. Light refreshments will be provided. Hope to see you there!



Thursday, April 11, 2019

Concurrent Afternoon Sessions, 1:30 pm-4:30 pm

E-1

ACDS Policy and Curriculum Updates

Level: Basic

ECE Core Knowledge: Professionalism and Leadership

ITMH Competency: None

Training Content Targeted Area: A

The Apprenticeship for Child Development (ACDS) program has recently completed a new four semester curriculum. This session will highlight the design of the new curriculum and review updates that have occurred in correlation to the implementation of the new curriculum. This session contains information for employers, apprentices, and instructors.

Presenters: Jennifer Conkle, MA, ACDS Statewide Coordinator, WVECTCR, River Valley Child Development Services, Huntington, WV and Kerri Wade, MA, Associate Professor, Assistant Director, Families and Health Unit West Virginia University Extension Service, Charleston, WV

E-2

Environmental Experiences for Early Childhood- WV Project Learning Tree

Level: Intermediate

ECE Core Knowledge: Child Growth and Development; Family and Community; Environment and Curriculum

ITMH Competency: None

Training Content Targeted Area: M

This workshop introduces formal and non-formal educators to Project Learning Tree's (PLT) Environmental Experiences for Early Childhood activity guide, and helps educators prepare for facilitating activities with young learners. Participants will receive the Environmental Experiences for Early Childhood activity guide, which includes over 130 experiences that engage children in outdoor play and exploration and is specifically designed for educators who work with children ages three to six. Topics include exploring nature with five senses, meeting neighborhood trees, and experiencing trees through the seasons. Accompanying music CD feature songs from children's musician Billy B. Brennan that encourages children to sing, dance, and move.

Presenter: Linda Carnell, Project Learning Tree Statewide Coordinator, WVDOF, Romney, WV; Tom

Oxley, Forester/PLT Facilitator, WVDOF, Charleston, WV; Andy Sheetz, Urban Partnership Coordinator/PLT Facilitator, Charleston, WV; Devin Wanner, USFS, Public Affairs Specialist/PLT Facilitator, Morgantown, WV; Claire Ferguson, AFHA Americorps member, Ed/Outreach Aide, Buckhannon, WV

E-3

Reflection through the Arts: Easy Practices for Busy Early Care Professionals

Level: Basic

ECE Core Knowledge: Professionalism and Leadership

ITMH Competency: Contemplation

Training Content Targeted Area: A

Early intervention professionals are increasingly working with young children and families who are under stress with significant challenges, leading to concerns for secondary trauma and worker burn out. Finding time for reflection and self-care is important, but often overlooked in our busy lives. Join us for this interactive session to learn meaningful, but easy art and writing activities that build reflective practice and extend your self-care tool kit in fun ways.

Presenters: Julie A. LaCreta, BS, LACA and Angela M. Tomlin, PhD., HSPP, IMH-E®, Indianapolis, IN

E-4

Put Me in Coach: The Power of Parent Coaching

Level: Intermediate

ECE Core Knowledge: Child Growth and Development; Family and Community Relationships; Child Observation and Assessment; Environment and Curriculum

ITMH Competency: Infant/Very Young Child & Family-Centered Practice

Training Content Targeted Area: T

Working with young children should include participation from their parents. However, getting parents involved in treatment can be difficult and many providers express frustration. When parents do want to be included, providers are often uncertain as to how to do this effectively. This presentation seeks to share an evidence-based model for including parents in treatment and teaching skills that can be practiced outside of the session together. Based on the Early Start Denver Model (ESDM). Strategies and techniques along with

a sample session outline will be discussed to optimize parent learning. Case studies and group activities will supplement the discussion.

Presenter: Christine Raches, PsyD, HSP, BCBA, Riley Child Development Center - LEND, Indiana University School of Medicine, Indianapolis, IN

E-5

Building Meaningful Experiences with STEAM

Level: Basic

ECE Core Knowledge: Environment and Curriculum

ITMH Competency: None

Training Content Targeted Area: M

During this session participants will create and build 2-D and 3-D structures to complete a STEAM challenge. They will complete a map of the process and connect the STEAM challenge to standards. They will view documentation about the challenge completed by other teachers and students. The origin of this idea will be discussed and how it was integrated into Pre-K through third grade classrooms. The session will begin with an introduction to the materials and how it started with a discussion about cities and landmarks with other children. The participants will walk through the challenge and then complete it. The challenge is to build five skyscrapers, two bridges, and two cars in a limited amount of space with the materials provided. They will have to create a map of their city and create two stories to present to the group.

Presenter: Amber Myers, MA, Pre-K/K Curriculum Specialist, Harrison County Board of Education, Fairmont, WV

E-6

Breastfeeding Basics

Level: Basic

ECE Core Knowledge: Health, Safety and Nutrition

ITMH Competency: Pregnancy & Early Parenthood

Training Content Targeted Area: I

This training discusses how breast milk is produced, breastfeeding compared to formula feeding, and how to encourage breastfeeding at a child care center.

Presenters: Renee Y. Stonebraker, RS, and Alex Binigar, WV Child Care Health Educators, WVECTCR, River Valley Child Development Services, Huntington, WV

E-7

Building Social Skills and Understanding for Children with Autism Spectrum Disorder

Level: Intermediate

ECE Core Knowledge: Child Growth and Development; Environment and Curriculum

ITMH Competency: None

Training Content Targeted Area: SN

This training will discuss the hidden curriculum that is in all walks of life and the importance of embedding social training in the home and classroom environments. Geared toward parents, teachers, aids, and SLPs, Age range will be school age.

Presenter: Peggy Hovatter, MA, Endorsed Positive Behavior Support Professional, WV Autism Training Center, Marshall University, Huntington, WV

E-8

Own Your Focus: Techniques to Dramatically Reduce Anxiety and Depression

Level: Intermediate

ECE Core Knowledge: Environment and Curriculum; Professionalism and Leadership

ITMH Competency: Self-Awareness

Training Content Targeted Area: S, A

Sharing the algorithm to transform lives. These techniques can be used from preschool throughout one's life. This Focus Mindset reduces anxiety, teaches goal setting, increases resilience, and improves the odds of a valuable future.

Presenter: Shannon Smith, M.D., Pediatrician, Speaker, Consultant, South Point, OH

E-9

When Survivors of Abuse Become Parents

Level: Basic

ECE Core Knowledge: Family and Community Relationships

ITMH Competency: Attachment, Separation, Trauma, Grief and Loss

Training Content Targeted Area: A

There is overwhelming research showing the impact of early adverse experiences on us as adults. How do the experiences of abuse in childhood affect us when we

become parents? In this session, we will explore some common challenges faced by survivors and identify supports that increase parenting success.

Presenter: Michelle Comer, LCSW, IMH-E®, HFA State Leader, TEAM for WV Children, Huntington, WV

E-10

Moving with Books, Props, and Songs...

Level: Basic

ECE Core Knowledge: Child Growth and Development

ITMH Competency: None

Training Content Targeted Area: P

Children were born to move, noting that activity and movement helps children develop not only their bodies, but also their brains, their ability to learn, and their social skills. It impacts not only physical development, but cognitive, social, and emotional development—the whole child. Movement and exercise for children should be as much of a habit as brushing teeth daily, but more fun. We will look at books, ideas, and hear songs that promote moving.

Presenter: Lisa Maddox-Vinson, BA, Instructor at Austin Peay State University, Owner at Get Connected with Lisa!, Dover, TN

E-11

Create Your Own Calm in a Sometimes Crazy World (Part 2)*

Level: Intermediate

ECE Core Knowledge: Child Growth and Development; Child Observation and Assessment; Environment and Curriculum

ITMH Competency: Self-Awareness

Training Content Targeted Area: P

Early care and education professionals will learn how to use a positive behavior support system, with an emphasis placed on the Conscious Discipline program. Brain states will be demonstrated so participants can understand how to maintain and promote self-regulation. Second part of a two part course. *Both Part 1 and 2 are required to obtain CEUs.

Presenter: Jane Haddox, BA, Early Education Station, Director/Owner, Pt. Pleasant, WV

E-12

ACES and Resiliency in Early Childhood: Systems Addressing Childhood Trauma in West Virginia

Level: Intermediate

ECE Core Knowledge: Family and Community Relationships; Health, Safety and Nutrition; Environment and Curriculum; Professionalism and Leadership; Administration and Management

ITMH Competency: Attachment, Separation, Trauma, Grief & Loss; Empathy and Compassion

Training Content Targeted Area: M

This workshop is designed to give attendees an overview of the landmark Adverse Childhood Experiences (ACEs) study and to discuss consequences over a lifetime. Attendees will also be able to discuss resiliency techniques and understand the effects of both ACEs and resiliency on the brain and body. This is applicable for adults who care for children of all ages. There will also be a presentation on the interconnected policies and programs for addressing systems of care for children in West Virginia.

Presenters: Michael R. Brumage, MD, MPH, Asst. Dean for Public Health Practice and Service, WVU School of Public Health, Morgantown, WV and Kelli Caseman, MA, Director of Child Health, West Virginians for Affordable Health Care, Charleston, WV

Don't forget to post pictures and videos while at the conference to Facebook or Instagram using hashtag #wvcc19 to win a chance for a FREE conference registration!



Spotlight Speakers

Friday, April 12
8:30-10:00 am



Little Theater

South Hall

“Bring Your ‘A’ Game to Work and Life”

“Nurturing Next Generation Innovators”

**Stephanie Staples,
Psychosocial Wellness Specialist,
Canada**

**Ellen Booth Church, Adjunct Professor,
Nova Southeastern University,
Durham, NC**

If you have ever been tired, overwhelmed, stressed and it's not even lunch time yet, you will need to hear this presentation. Stephanie has burnt out and bounced back and she knows firsthand that we can only do good if we feel good and we can only feel good if we are willing to look at our lives beyond our work.

Journey on this high energy, no holds barred presentation as Stephanie peels the layers back and exposes not only what you need to do to achieve uncommon success in your life and livelihood but how to do it.

Stephanie Staples is a Certified Speaking Professional who shares her insights, ideas and inspiration on personal and professional development everywhere from the Mayo Clinic to the Middle East. Her eclectic background in healthcare, fitness, and communication ensures a unique approach to psychosocial wellness for caregivers.

Albert Einstein said, *“The measure of intelligence is the ability to change.”* Look around and you will see how the world is growing and changing at an increasingly rapid pace. The classroom community is becoming a global community. The children we are teaching now will need to know how to function in this ever-changing, ever-expanding global world. This will take an ability to think and problem-solve using both creative and critical thinking skills. At the same time, children will need to know how to function socially and emotionally with an awareness of needs and feelings of others. Let's prepare children for the Global Community through play-based and research-based activities that expand their thinking and open their hearts!

Well known early childhood educator, Ellen Booth Church spent several years as both a Pre-K and Kindergarten teacher before becoming an early childhood assistant professor at the State University of New York. She is currently an adjunct professor at Nova Southwestern University, an educational consultant, keynote speaker, curriculum/product developer, and writer dedicated to enriching the lives of young children and their families.

Friday, April 12, 2019

Concurrent Morning Sessions, 10:30 am-12:00 pm

F-1

Sensory Processing Disorder 101

Level: Basic

ECE Core Knowledge: Child Growth and Development; Environment and Curriculum

ITMH Competency: Infant/Very Young Child Development & Behavior

Training Content Targeted Area: M

Sensory Processing Disorder is a term we are hearing more and more in our world. In this presentation, we will explore what sensory processing disorder is, briefly touching on the prevalence of this disorder. We will spend the bulk of the presentation discussing the different types of sensory processing disorder and how to support children with these disorders in your preschool environment with simple activities that will benefit all children in your class.

Presenter: Ingrid M. Kanics, OTR/L, FAOTA, President, Kanics Inclusive Design Service, LLC, New Castle, PA

F-2

It Takes a Village (But the Village Needs Training Too)

Level: Basic

ECE Core Knowledge: Family and Community; Administration and Management

ITMH Competency: None

Training Content Targeted Area: M

Kanawha County is the fourth largest but most populated county in West Virginia. Here, an estimated 1 in 5 adults are functionally illiterate (compared to the national average of 1 in 7). With such a large and populous area, there is a unique set of challenges. LVKC (a completely volunteer run group) is embarking on a year of expanded reach, using literacy to address programs from school retention to opioid recovery. By April 2019, we will be able to present on what we found was both successful and unsuccessful, and how the audience can apply this to their own outreach work. LVKC works with a mixed age range, ages 7 and up.

Presenter: Erin McGrath, AmeriCorps*VISTA, Coordinator, Literacy Volunteers of Kanawha County, Charleston, WV

F-3

The Arts as an Approach to Learning

Level: Intermediate

ECE Core Knowledge: Child Growth and Development; Environment and Curriculum

ITMH Competency: None

Training Content Targeted Area: P, S

If our goal in early childhood education is to prepare children to learn, then experiential learning is key. Real world experiences open their world to the big world. In this workshop, we will explore and discover the hidden value of arts integration as an approach to teaching and learning.

Presenter: Jeffrey Leffler, Ph.D., Interim Director, Southern Early Childhood Association, Hattiesburg, MS

F-4

Assistive Technology and Transition: What's the Plan?

Level: Intermediate

ECE Core Knowledge: Child Growth and Development, Family and Community Relationships, Professionalism and Leadership

ITMH Competency: Infant/Very Young Child Development and Behavior

Training Content Targeted Area: M, SN

When evaluating for tools to increase independence, we have often failed to look beyond the here and now. While it is very important to ensure we are choosing the correct tools for the current situation, it is just as important to plan for the future. Children with disabilities are faced with enough obstacles without having to learn how to use a new tool every time their placement changes. This presentation will discuss strategies for identifying transition friendly devices and transition planning for assistive technology.

Presenter: Jessi Wright, WVATS Program Manager, WVUCED, Morgantown, WV

F-5

The Idea Bank - Inspiration to Action

Level: Intermediate

ECE Core Knowledge: Professionalism and Leadership
ITMH Competency: Building and Maintaining Relationships
Training Content Targeted Area: A

For people that have room for improvement in their life and are ready to move from just having ideas to putting them into action. Building on the Bring Your 'A' Game program, this interactive session will have participants creating an action-oriented plan to make their ideas for improved work, collegial and personal relationships better, craft the experiences they desire, overcome obstacles that may cause blocks and have the grit and resilience to keep moving toward their goals.

Presenter: Stephanie Staples, CSP - Certified Speaking Professional, Psychosocial Wellness Specialist, Canada

F-6

How We Talk with Children and the Art of Asking the Right Questions

Level: Intermediate
ECE Core Knowledge: Environment and Curriculum
ITMH Competency: Infant/Very Young Child Development & Behavior
Training Content Targeted Area: P

Studies are showing that brain development and thinking skills are built through hands-on experiences with open-ended materials, language interactions/explorations and deep discussion. The key is in asking the open-ended questions that build language, critical and creative thinking, and problem solving skills. This session is interactive and excellent for those who work with preschool children.

Presenter: Ellen Church Booth, Adjunct Professor, Nova Southeastern University, Durham, NC

F-7

River Valley CARES: Bringing it Together

Level: Intermediate
ECE Core Knowledge: Family and Community Relationships
ITMH Competency: Community Resources
Training Content Targeted Area: I, T, A

This course is designed to provide audience members a better understanding of the River Valley CARES program, why this program is so important, the services being provided, and how all the different components

are working in collaboration to address the challenges of infants born with Neonatal Abstinence Syndrome (NAS) or exposed to Substance Use Disorder (SUD) and their families/caregivers.

Presenters: Janie Fuller-Phelps, MS, MA, LSW, Director, River Valley CARES, Huntington, WV; Kalpana Miriyala, MD, Assistant Professor, Child and Adolescent Psychiatry, Dept. of Psychiatry and Behavioral Medicine, Marshall University School of Medicine, Huntington, WV; Amanda Patrick, BSW, Family Navigator, River Valley CARES, Huntington, WV; Deidra Beckett, MSW, LGSW, Family Navigator, Healthy Connections, Huntington, WV

F-8

Embracing the Concept of STEAM in Early Childhood Education

Level: Intermediate
ECE Core Knowledge: Child Growth and Development; Environment and Curriculum
ITMH Competency: None
Training Content Targeted Area: P

This session is focused on the concept of providing STEAM activities that are developmentally appropriate for students in early childhood education. STEAM should be fun filled with the joy of discovery. STEAM is fun and factors collaboration and critical thinking. Preschool teachers will gain a new insight into the wonders of STEAM. The activities presented are fun, easy, and meant to open up students to an exciting experience that goes beyond the equipment.

Presenters: Wesley Ezell, Pre-K Director, Doddridge County Schools, WV and Betsy Wells, MA, Preschool Teacher, Doddridge County Schools, WV

F-9

The Early Start Denver Model - An Overview

Level: Basic
ECE Core Knowledge: Child Growth and Development
ITMH Competency: Community Resources
Training Content Targeted Area: I, T, SN

This presentation will provide the participants with an introduction and overview of the Early Start Denver Model (ESDM). Participants will learn how a pilot group of WVBTT practitioners are incorporating the ESDM model into their visits with young children with ASD and their families. A panel including speech language

pathologists, developmental specialists, occupational and physical therapists will provide the participants with descriptions and discussion about using ESDM while serving their WVBTT families.

Presenters: Karen Randolph, Speech and Language Pathologist, WV Birth to Three, WV; Kristi DeLeuere, Occupational Therapist, WV Birth to Three, WV; Christine Neighbors, Developmental Specialist, WV Birth to Three, WV

F-10

Managing Your Early Childhood Program through the Program Administration Scale (PAS) - Part 1*

Level: Intermediate
ECE Core Knowledge: Administration and Management
ITMH Competency: None
Training Content Targeted Area: A

This program is designed for program directors of child care centers. The directors will have the opportunity to learn how to use the PAS, do their own assessment of their practices, while also sharing ideas with others. This is a two part course. *Both Parts 1 and 2 are required to receive CEUs.

Presenter: Suzi Brodof, MA, Executive Director, River Valley Child Development Services, Huntington, WV

F-11

What Happens to Children When Parents Go To Prison - Part 1*

Level: Intermediate
ECE Core Knowledge: Child Growth and Development; Family and Community Relationships; Environment and Curriculum
ITMH Competency: Attachment, Separation, Trauma, Grief & Loss
Training Content Targeted Area: M

The US incarcerates more people than any other country. People who are incarcerated are just as likely to be parents as anyone else; therefore, literally millions of US children have a parent in prison or jail. When parents are in prison or jail, children experience significant stressors and changes that can affect their behavioral and emotional status. Learn the effects of parental incarceration on young children and how early childhood professionals can make a difference. *Both Parts 1 and 2 are required to receive CEUs.

Presenter: Angela M. Tomlin, PhD, HSPP, IMH-E®, Director, Riley Child Development Center, IN

F-12

Helping Children with Math and Science Thinking

Level: Basic
ECE Core Knowledge: Environment and Curriculum
ITMH Competency: None
Training Content Targeted Area: P

There is growing understanding and recognition of the power of children's early thinking and learning as well as a belief that science and math may be a particularly important domain in early childhood, serving not only to build a basis for future scientific understanding but also to build important skills and attitudes for learning. Come explore and learn how to encourage science and math exploration, interest, and curiosity.

Presenter: Lisa Maddox-Vinson, BA, Instructor at Austin Peay State University, Owner at Get Connected with Lisa!, Dover, TN

F-13

Leadership in Action

Level: Basic
ECE Core Knowledge: Professionalism and Leadership
ITMH Competency: None
Training Content Targeted Area: A

During this session, child care center directors will learn how they can create and sustain a compelling vision for their program that transforms their center into a vibrant and engaging learning community. It will help to understand the subtle but important distinction between leadership as a role and leadership as a set of skills and competencies that can be supported and nurtured at all levels of the program.

Presenters: Elizabeth Teel, BS, Tiered Reimbursement/QRIS State Coordinator, Division of Early Care and Education, WV DHHR; Shante' Ellis, M.Ed., Quality Improvement Specialist, Connect Child Care Resource and Referral; Sarah Harvey, M.Ed., Quality Improvement Specialist, Choices Child Care Resource and Referral; Jaime Price, MS, Quality Improvement Specialist, MountainHeart Child Care Resource and Referral North; Linda Prutsok, BA, Quality Improvement Specialist, MountainHeart Child Care Resource and Referral South; Jessica Wilcoxon, BA, Quality Improvement Specialist, Link Child Care Resource and Referral, WV

Friday, April 12, 2019

Concurrent Afternoon Sessions, 1:30 pm-3:00 pm

G-1

It's a Sensory Rich World! Let's Get Out and Play!

Level: Basic

ECE Core Knowledge: Child Growth and Development; Environment and Curriculum

ITMH Competency: Infant/Very Young Child Development & Behavior

Training Content Targeted Area: M

This session will share the importance of sensory play to promote healthy development for every child! The seven senses will be discussed and a wide variety of sensory play experiences in each domain will be given to help teachers build their sensory play toy box for their children to enjoy.

Presenter: Ingrid M. Kanics, OTR/L, FAOTA, President, Kanics Inclusive Design Service, LLC, New Castle, PA

G-2

Parents as Leaders: Ready for the Challenge?

Level: Basic

ECE Core Knowledge: Family and Community Relationships

ITMH Competency: Building & Maintaining Relationships

Training Content Targeted Area: A

This session is about parent leadership and the essential elements needed for a successful educational team about a child who has special needs. The presentation is focused upon professionals and parents who work together in order to provide a roadmap for a child's education. The key element to building this successful team does not happen without preparing and having components necessary for building the roadmap for a child's education. The information targets the adults (parents and professionals) who are working together for a child with special needs educational plan. Parents may take a leadership role in this process.

Presenters: Julie Dial, West Virginia Parent Training and Information Trainer, WVPTI, Region 3, WV and Brenda Lamkin, Executive Director of West Virginia Parent Training and Information, WV

G-3

Inclusive Play

Level: Basic

ECE Core Knowledge: Child Growth and Development;

Environment and Curriculum

ITMH Competency: Infant/Very Young Child Development & Behavior

Training Content Targeted Area: M

Inclusive Play will discuss the importance of play for all children of all abilities. Attendees will learn ways to create inclusive play opportunities utilizing assistive technology. Switch enabled toys will be demonstrated as well as adapted balls and other recreation items that can be used at home, in the community, and in the classroom to increase the inclusion of all children in play. Attendees will also learn how to adapt battery powered toys to switch access. Target age range is birth to five.

Presenter: Jennifer Ham, BA, AT Specialist, WVATS, Morgantown, WV

G-4

What's Hiding in the Box? iPad Accessibility

Level: Basic

ECE Core Knowledge: Child Observation and Assessment, Environment and Curriculum

ITMH Competency: None

Training Content Targeted Area: M, SN

Assistive Technology is no longer limited to specialized equipment. Assistive tools can now be found nearly anywhere and is often disguised as mainstream technology. The trick for taking a mainstream tool and turning it into an assistive tool is identifying the tool's features that help increase independence. Apple has a wide array of built-in accessibility features designed to make the devices especially useful to individuals with disabilities. This hands-on presentation will demonstrate a variety of continuously updating accessibility features in Apple devices. **Bring your own device and find out what's hiding inside the shiny box! Devices will not be provided.**

Presenter: Jessi Wright, WVATS Program Manager, WVUCED, Morgantown, WV

G-5

Implementing Activities for Preschoolers and their Families using Children's Literature

Level: Basic

ECE Core Knowledge: Child Growth and Development;

Family and Community Relationships

ITMH Competency: None

Training Content Targeted Area: P

The Glenville State College Early Education Student Group will share a variety of hands-on learning activities appropriate for preschoolers to encourage overall development with a focus on family involvement. Connections to children's literature will be shared. Activities will relate to areas of cognitive, social, emotional, creative, and physical development. Activities will also be developmentally appropriate for preschool aged children.

Presenters: Connie Stout O'Dell, MA, Director of Field Experiences, Glenville State College, Glenville, WV and Shelly Ratliff, EdD, Associate Professor of Education, Glenville State College, Glenville, WV

G-6

WV Resources for Serving Infants and Toddlers with Sensory Loss

Level: Basic

ECE Core Knowledge: Child Growth and Development; Family and Community Relationships; Child Observation and Assessment

ITMH Competency: Community Resources

Training Content Targeted Area: I, T, P, SN

WV BTT Implementation Team for Infants and Toddlers with Sensory Loss has been collecting and developing targeted resources to support early intervention teams in identifying and serving infants and toddlers with vision and/or hearing loss. Resources include risk factors, early warning signs, roles and responsibilities, early intervention framework for practitioners on Deaf blindness, etc. Highlighted will be the new comprehensive WV Resource Guide for Families of Children with Hearing Loss (birth to five) and the draft WV Resource Guide for Families of Children with Vision Loss.

Presenter: Annette Carey, West Virginia Birth to Three Vision and Hearing State Implementation Team, Charleston, WV

G-7

Empowering Positive Behavior Through Supportive Environments

Level: Intermediate

ECE Core Knowledge: Child Growth and Development; Environment and Curriculum

ITMH Competency: Infant/Very Young Child

Development & Behavior

Training Content Targeted Area: M

Challenging behavior is an obstacle that many educators and families struggle with. It not only hinders education, it creates barriers for families and children, causing immense stress for all involved. Join us in discovering how we can set up environments that not only support children with challenging behaviors but create a classroom community that empowers positivity. This training is helpful for classroom teachers working with toddlers through Pre-K students.

Presenters: Tracee Hinkle, MA, IMH-E®, Positive Behavior Support Coordinator, Playmates Preschools and Child Development Centers, Inc. and Amanda Perdue Kent, BA, Site Director, Playmates Preschools and Child Development Centers, Inc., Barboursville, WV

G-8

Visual Supports in Action: Strategies for Using Visual Supports Functionally and with Fidelity

Level: Intermediate

ECE Core Knowledge: Child Growth and Development; Child Observation and Assessment; Environment and Curriculum

ITMH Competency: None

Training Content Targeted Area: M, SN

Visual and Environmental Supports foster communication, positive behavior, self-regulation, independence, and learning in preschool through secondary learning environments, as well as at home. Possibilities span from no-tech to high-tech tools and strategies, but the tools alone are often not enough. Teaching and tweaking are needed to implement such tools and strategies with fidelity to achieve desired outcomes. This session will investigate the impact of sensory considerations and development of executive functioning skills on the customization of visual and environmental supports. Ample examples of visual and environmental supports across targeted areas will be showcased. Discussion will unpack strategies for teaching and implementing visual and environmental supports as well as provide tips for re-evaluating when things do not go as planned.

Presenter: Tabitha Jones-Wohleber, M.S., CCC-SLP, Assistive Technology Specialist, Communication AACtualized LLC, Shepherdstown, WV

G-9

Supporting Families through Miscarriage and Infant Loss

Level: Intermediate

ECE Core Knowledge: Family and Community Relationships

ITMH Competency: Attachment, Separation, Trauma, Grief & Loss

Training Content Targeted Area: HV, A

What happens when a home visitor follow up on a referral to the program only to find out the family has experienced a miscarriage? How do we best support parents through this and other types of perinatal loss? In this session, participants will learn about the response from one home visitation program in WV, as well as supports that have been developed in other parts of the country.

Presenter: Michelle Comer, LCSW, IMH-E®, HFA State Leader, TEAM for West Virginia Children, Huntington, WV

G-10

Managing Your Early Childhood Program through the Program Administration Scale (PAS) - Part 2*

Level: Intermediate

ECE Core Knowledge: Administration and Management

ITMH Competency: None

Training Content Targeted Area: A

This program is designed for program directors of child care centers. The directors will have the opportunity to learn how to use the PAS, do their own assessment of their practices, while also sharing ideas with others. This is a two part course. *Both Parts 1 and 2 are required to receive CEUs.

Presenter: Suzi Brodof, MA, Executive Director, River Valley Child Development Services, Huntington, WV

G-11

What Happens to Children When Parents Go To Prison - Part 2*

Level: Intermediate

ECE Core Knowledge: Child Growth and Development; Family and Community Relationships; Environment and Curriculum

ITMH Competency: Attachment, Separation, Trauma, Grief & Loss

Training Content Targeted Area: M

The US incarcerates more people than any other country. People who are incarcerated are just as likely to be parents as anyone else; therefore, literally millions of US children have a parent in prison or jail. When parents are in prison or jail, children experience significant stressors and changes that can affect their behavior-

al and emotional status. This session will review the effects of parental incarceration on young children and explain how early childhood professionals can make a difference through positive relationships. *Both Parts 1 and 2 are required to receive CEUs.

Presenter: Angela M. Tomlin, PhD, HSPP, IMH-E®, Director, Riley Child Development Center, IN

G-12

You Are Special

Level: Intermediate

ECE Core Knowledge: Child Growth and Development; Environment and Curriculum; Professionalism and Leadership

ITMH Competency: Professional/Personal Development

Training Content Targeted Area: P

The words and music of Mr. Fred Rogers will be used to inspire and encourage the leadership development of individuals working with *preschool and school age children*. Appropriate adult/child interactions will be addressed to encourage positive social and emotional development of young children. Creative art and children's literature will be shared as examples of curriculum activities that encourage positive self-esteem.

Presenter: Nancy Cheshire, MEd, Past President of Southern Early Childhood Association (SECA), Bridgeport, WV

G-13

New Opportunities with WV STARS: Pathway Advancement Scholarship and Pathway to Earnings

Level: Basic

ECE Core Knowledge: Professionalism and Leadership

ITMH Competency: None

Training Content Targeted Area: A

Child care providers and directors working in a licensed child care center or facility and registered family home providers will learn how the new WV STARS Pathway Advancement Scholarship can help them earn a degree and move up the Career Pathway, while Pathway to Earnings can provide them a supplemental wage for earnings, a degree, or certain certificates. We will discuss the requirements, the application process, and the award opportunities.

Presenter: Sarah Bailey, BA, WV STARS Pathway Advancement Scholarship and Pathway to Earnings Specialist, WVECTCR, River Valley Child Development Services, Huntington, WV

FIRST FLOOR

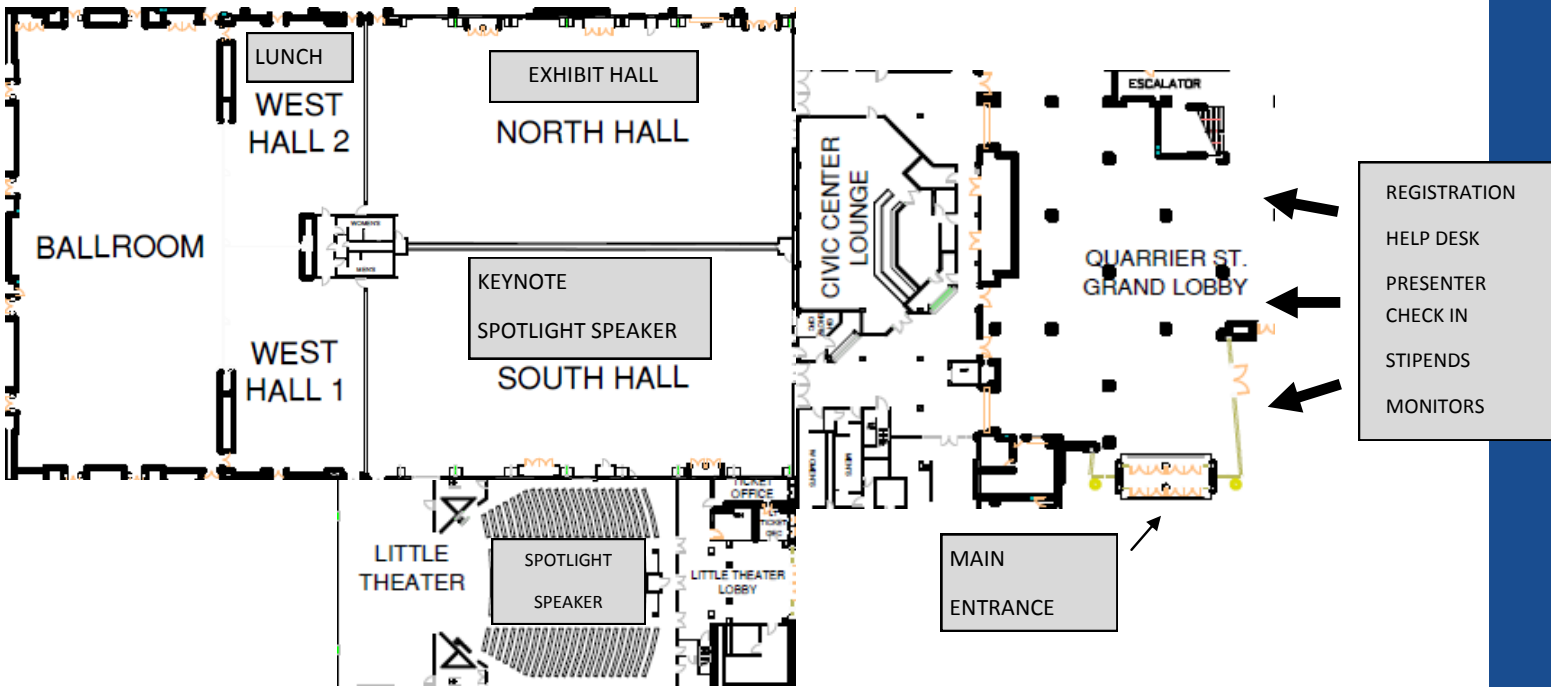

QUARRIER STREET PARKING GARAGE

SECOND FLOOR

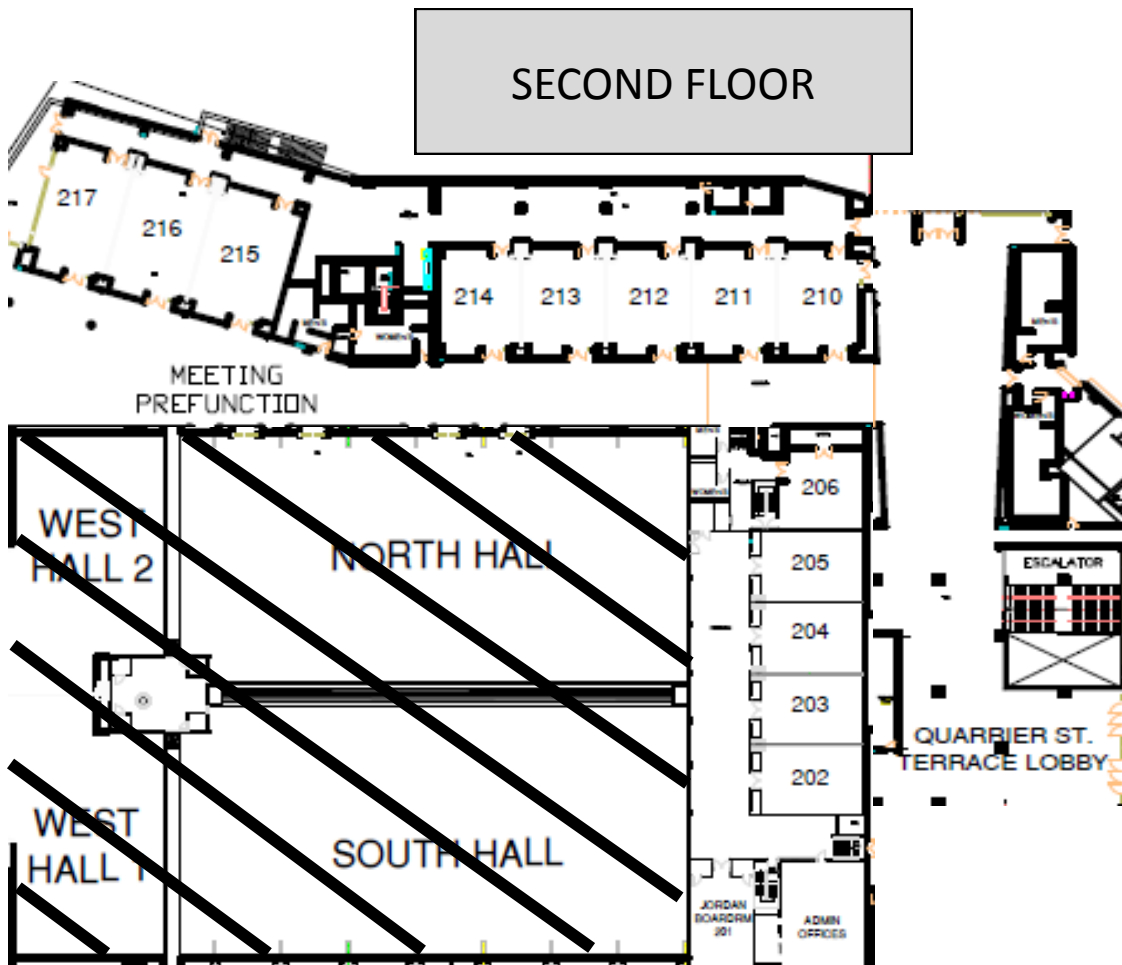

Conference Registration Information

How Do I Get Started?

Please use the registration form on the next page to register. Feel free to copy the registration form for EACH INDIVIDUAL person. Please do not use one form for an entire agency or program.

Please indicate a first, second and third choice of workshops. If you only indicate ONE choice and that workshop is FULL, you will be assigned a workshop by the conference committee. Therefore, it is imperative you indicate alternative choices to ensure you will receive a workshop that is valuable to you.

Please fill out the registration form completely. Make sure you list a complete address or we will not be able to mail your name badge and confirm your registration. Please write the appropriate session letter and number found at the beginning of each workshop description.

What Happens if My Workshop Is Full?

When your first choice workshop is full, you will receive your second choice, if possible. If your second choice is also full, your third choice will be assigned.

How Do I Know What Workshops I Am Registered to Attend?

You will receive your name badge in the mail after you register. On the name badge, you will find your workshop assignments. If the workshops you are assigned were not your first choice, please understand your first choice was not available.

What Are the Payment Procedures?

Registrations WILL NOT be processed without FULL PAYMENT (check, credit card, money order or purchase order). Payment MUST accompany your registration form or your registration will be mailed back to you UNPROCESSED. If you are attending the conference from an agency who has a central accounting office, please advise the office that payment or purchase order must be received with registration(s). Purchase orders must be paid upon receipt of invoice.

When sending payment, please indicate the name(s) of the participant(s) that are included in the payment. We want to make sure the correct participant(s) are credited. Please make payment to: **River Valley Child Development Services (RVCDS)**.

What Are the Benefits of Registering Early?

Registering early not only helps ensure workshop selec-

tions, but is also the greatest savings. You can save up to \$50.00 by registering early! Early registration deadline is March 15, 2019. Registrations must be POSTMARKED by this date or they will be returned UNPROCESSED. If your registration is unprocessed, you need to bring your registration and payment (check, credit card, money order, purchase order only) with you to the conference for on-site registration.

What Do I Do if I Am Registering After March 15, 2019?

You will need to bring your registration form and check, credit card, purchase order or money order (cash will not be accepted) with you to the conference for on-site registration. Any registration forms sent to the WVECTCR office after March 15, 2019, will be returned UNPROCESSED.

What Does the Registration Fee Include?

Registration fees include admission to conference workshops, Exhibit Hall and keynote presentations. The fee also includes your name badge and tote bag.

Where Do I Send My Registration?

Please complete the registration form, attach payment, and send to RVCDS, Attn: Celebrating Connections, 611 Seventh Ave., Ste. 322, Huntington, WV 25701.

What Is the Cancellation/Refund Policy?

Cancellation or refund requests must be written, signed, and approved (fax accepted). A \$10 processing fee is assessed if received by Feb. 28, a \$15 processing fee if received between March 1-7, and a \$25 fee if received between March 8-14. No refunds available after March 15. The only exception will be if a state of emergency is issued by the Governor. Please allow 4-6 weeks for processing. Checks returned constitute failure to register and result in return of registration materials. You may re-register by credit card or money order. Bank charges incurred by Training Connections must be included. Purchase orders constitute payment and are subject to the refund policy.

Where Do I Pick Up Conference Items?

At the conference, the PRE-REGISTERED LINE will be designated for people who have already received name badges and confirmation letters. The ON-SITE REGISTRATION LINE will be for people who need to register on-site. The HELP LINE will be for people who have questions or need to request a new name badge. There will also be a STIPEND LINE for those receiving stipends.

Conference Registration Form

Days	Early Bird Rate (Postmarked by 3/15/19)	On-Site Rate (After 3/15/19) <small>Accepted at Civic Center Only</small>
------	--	---

General Conference Institutes and Sessions:		
<input type="checkbox"/> All Three Days	\$225	\$275
<input type="checkbox"/> Any Two Days	\$150	\$200
<input type="checkbox"/> Any One Day	\$75	\$125

Wednesday All Day Institutes:
<input type="checkbox"/> A-1: Using Play-Based and Routines-Based Observation to Examine Executive Function in Young Children
<input type="checkbox"/> A-2: Infant and Toddler Trauma: Caring for Yourself While Caring for Others
<input type="checkbox"/> A-3: Nurturing the Substance-Exposed Young Family: Hope in the Face of Adversity
<input type="checkbox"/> A-4: CAPS Poverty Simulation
<input type="checkbox"/> A-5: How to Incorporate Low Tech AAC Throughout Your Day
<input type="checkbox"/> A-6: Just Follow the Leader: Oh, I'm the Leader!

Workshop Selections: You MUST indicate 3 choices

Choice: Please fill in the number next to the letter	Wednesday 9 am-12 pm (B1-B2)	Wednesday 1-4 pm (C1-C2)	Thursday 10:30 am- 12 noon (D1-D13)	Thursday 1:30-4:30 pm (E1-E12)	Friday 10:30 am- 12 noon (F1-F13)	Friday 1:30-3 pm (G1-G13)
FIRST	B	C	D	E	F	G
SECOND	B	C	D	E	F	G
THIRD	B	C	D	E	F	G

Payment method ****Please make checks out to River Valley Child Development Services (RVCDS)****

My payment method is:	Personal Check	Agency Check	Purchase Order	Money Order	Credit Card
Please fill in check # or PO # in the appropriate space	Check #	Check #	PO#	Check#	Type (circle one) Visa MC Discover (see below) <small>*AMEX is NOT accepted</small>

Credit Card Information:

Name on Card: _____ Card #: _____
 Billing Address and Zip: _____
 Exp. Date: _____ Security Code: _____ Signature: _____

Hotel Rates and Reservations

All reservations for hotel accommodations should be handled directly with the hotels. Special room rates are available for conference participants at the following hotels throughout the event. The cut-off date for the discounted rate varies with each hotel. Please refer to the following information for specifics. Reservations made after the cut-off date will be subject to room availability, and group rates may not apply. Rates are subject to change.

Charleston Marriott
 200 Lee Street East
 (304)345-6500
 \$134.00 plus tax
 Cut-off date: March 18, 2019
 Code: Celebrating Connections
 WVDE 2019

Embassy Suites
 300 Court Street
 (304) 347-8700

Holiday Inn Civic Center Express
 100 Civic Center Drive
 (855)729-5133
 \$116.00 plus tax
 Cut-off date: March 15, 2019
 Code: CCE

Charleston Capitol Hotel
 1010 Washington Street, E
 (304)343-4661

Four Points by Sheraton
 Charleston
 600 Kanawha Blvd, E.
 (304)324-4409
 \$124.00 plus tax
 Cut-off date: March 9, 2019
 Code: Celebrating Connections

Holiday Inn and Suites
 400 Second Avenue
 (304)744-4641

Courtyard Marriott
 100 Kanawha Blvd, E
 (304)344-5777
 \$139.00 plus tax
 Cut-off date: March 8, 2019
 Code: Celebrating Connections

Fairfield Inn and Suites
 Charleston
 402 Second Avenue SW
 (304)744-4444
 \$99.00 plus tax
 Cut-off date: March 25, 2019
 Code: CEL

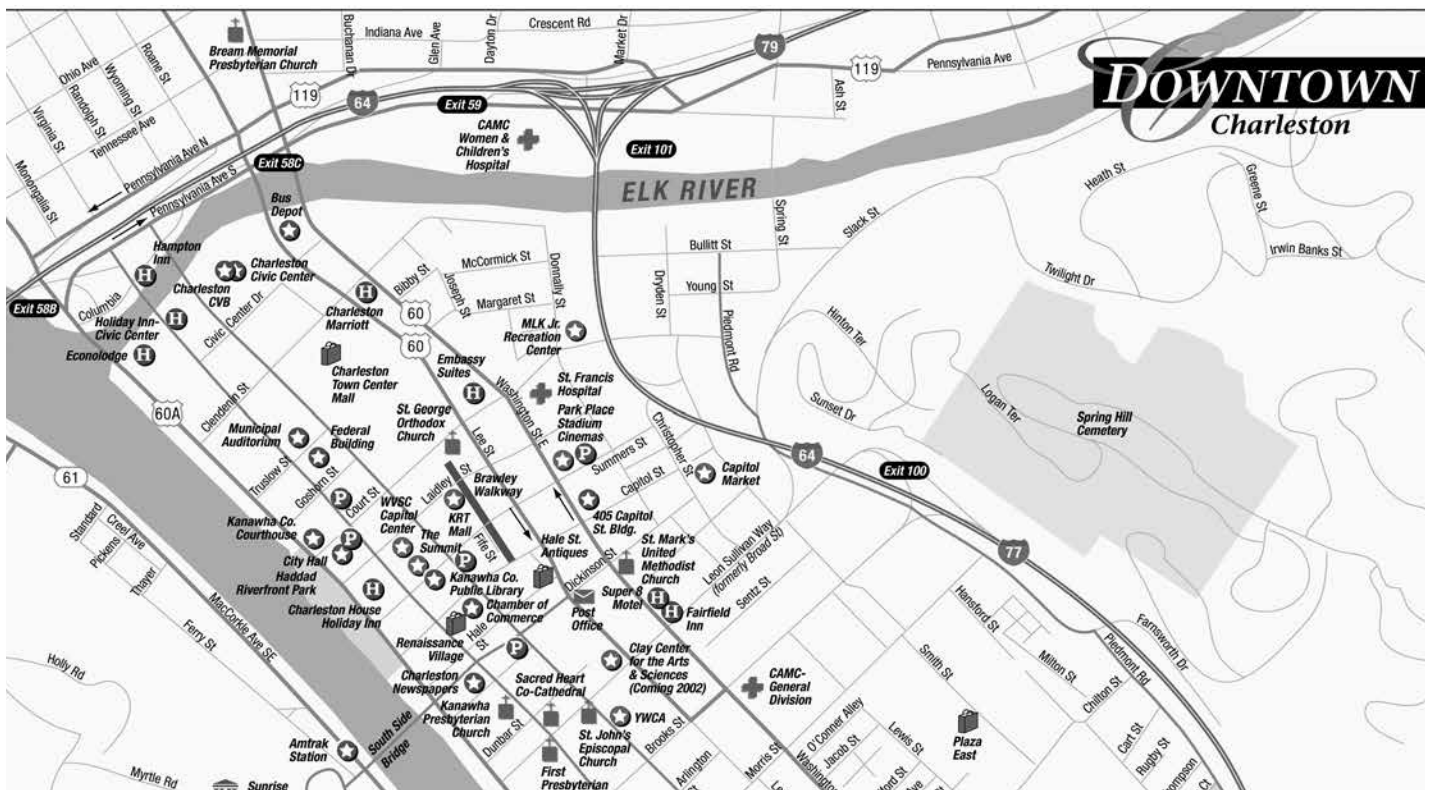

Continuing Education Unit (CEU) Reporting Form/Certificate of Attendance

Approved Provider Description/Title--Twenty Second Annual Celebrating Connections Conference

April 10-12, 2019 at the Charleston Civic Center, Charleston, WV

Please complete, sign, and submit as required by your licensing, certification, etc., entity. It is your responsibility to follow the appropriate protocol. Make a copy of this completed form for your records.

PLEASE INDICATE THE SESSIONS YOU ATTENDED AND TOTAL HOURS BELOW.

Name _____ Social Security Number _____

Mailing Address _____

Type of License _____ State(s) and License(s) Number _____

Approved Provider Name - Celebrating Connections Conference - Individual Approved Provider

Approved Provider Number _____ (See CEU table for Approved Provider Number)

WEDNESDAY, APRIL 10, 2019: ONE DAY INSTITUTES

APPROVED

ACTUAL

6 Hours _____ A- _____
(Workshop Number and Title)

WEDNESDAY, APRIL 10, 2019: 3 HOUR SESSIONS

APPROVED

ACTUAL

3 Hours _____ B- _____
(Workshop Number and Title)

3 Hours _____ C- _____
(Workshop Number and Title)

THURSDAY, APRIL 11, 2019

APPROVED

ACTUAL

1.25 Hours _____ Keynote: _____

1.5 Hours (A.M.) _____ D- _____
(Workshop Number and Title)

3 Hours (P.M.) _____ E- _____
(Workshop Number and Title)

FRIDAY, APRIL 12, 2019

APPROVED

ACTUAL

1.25 Hours _____ Spotlight Speaker: _____

1.5 Hours (A.M.) _____ F- _____
(Workshop Number and Title)

1.5 Hours (P.M.) _____ G- _____
(Workshop Number and Title)

TOTAL HOURS EARNED: _____ Note: You may only claim credit for the hours or portions of hours you actually attended. If required by your licensing, certification, etc., entity, present this certificate to a Celebrating Connections representative at the CEU table for a signature upon completion.

Celebrating Connections Representative Signature _____ Date _____

Certification: "In signing this form, I certify that I have attended and completed the continuing social work education contact hours, WV Birth to Three contact hours, or other continuing education contact hours indicated above. I also understand that continuing education hours must be earned to renew my license(s) and that knowingly falsifying records could result in disciplinary action, including suspension or revocation of my license(s)." 33

Certificate of Attendance

This certificate is awarded to

Celebrating Connections Conference in Charleston, WV

April 10-12, 2019

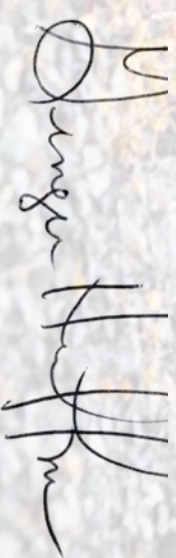

Conference Committee Signature





RVCDS/WVECTCR
611 Seventh Avenue
Suite 300
Huntington, WV 25701

NONPROFIT ORGANIZATION
US POSTAGE
PAID
PERMIT NO 43
HUNTINGTON WV